

Pipe Shaft SFC_g6

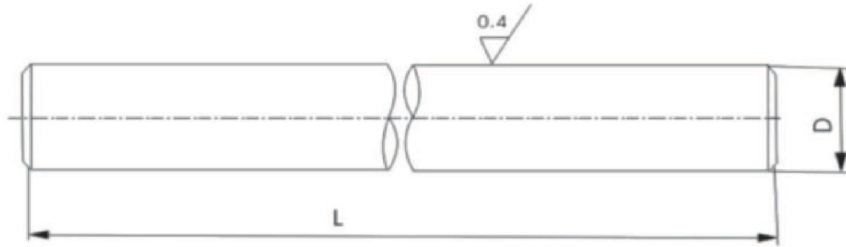

MODEL	INSCRIBED CIRCLE DIAMETER	DIMETER TOLERANCE		DEPTH OF EFFECTIVE HARDEN LAYER	WEIGHT
		g6	h6		
SFC6	6	-0.004 -0.012	0 -0.008	0.4~1	0.22
SFC8	8	-0.005 -0.014	0 -0.009	0.4~1	0.4
SFC10	10	-0.005 -0.014	0 -0.009	0.6~1.5	0.62
SFC12	12	-0.006 -0.017	0 -0.011	0.6~1.5	0.89
SFC13	13	-0.006 -0.017	0 -0.011	0.6~1.5	1.04
SFC16	16	-0.006 -0.017	0 -0.011	0.8~2	1.58
SFC20	20	-0.007 -0.02	0 -0.013	0.8~2	2.47
SFC25	25	-0.007 -0.02	0 -0.013	0.8~2	3.85
SFC30	30	-0.007 -0.02	0 -0.013	0.8~3	5.55
SFC35	35	-0.009 -0.025	0 -0.016	0.8~3	7.55
SFC40	40	-0.009 -0.025	0 -0.016	0.8~3	9.87
SFC50	50	-0.009 -0.025	0 -0.016	0.8~3	15.4